

8

7

6

5

4

3

DATE	REV. NO.	DESCRIPTION	REV.	DATE
PT	1			

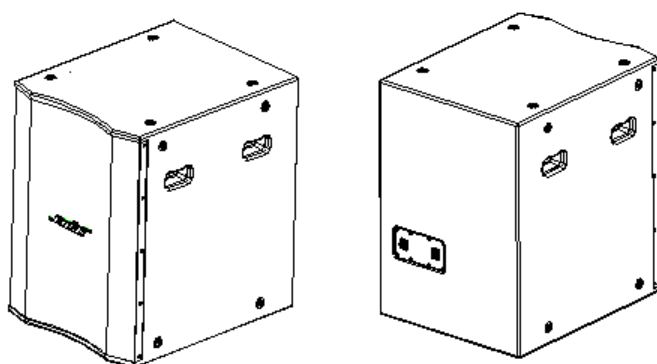
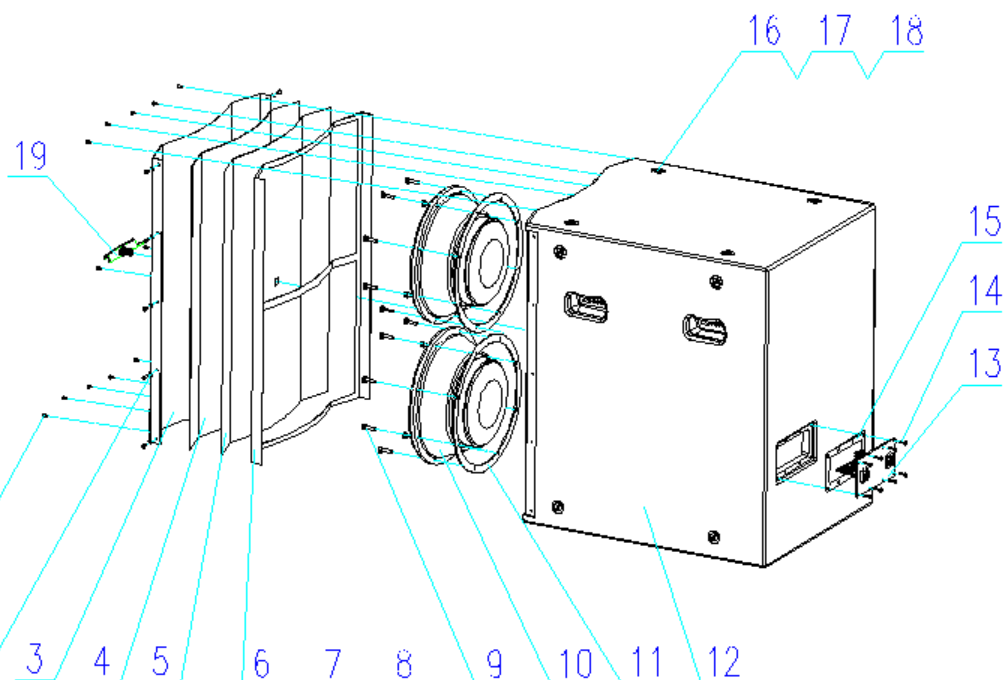

NOTES:

1. MATERIAL: SEE BOM
2. FINISH: N/A
3. COSMETIC AND ACOUSTIC TESTING PER BOSE TEST SPECIFICATION TSXXXXXX
4. PRODUCT VALIDATED: PER BOSE VALIDATION PLAN VPXXXXXX
5. CONTROL CHARACTERISTICS (C) TO BE PER BOSE OPERATING PROCEDURE OP148887.

BOSE/LT MB24-WR BOM						
Speaker BOM						
#	Elder Part No.	DWG. Title	Specification	DWG.	Qty	BOSE Part No.
1	B-L34-06	screw	T4.7*12mm/A/stainless/black	LT97902-III-117	22pcs	
2	4-L3D-01	washer	Flat washer 4*9*0.8		10PCS	
3	B-MRW-SM001	grill	BOSE/MB24-III stainless	LT_MB24-III-106	1pcs	
4	B-XTM-06	foam	TA 675mm*515mm*4.5mm		1pcs	
5		cloth	675mm*515mm		1pcs	
6	B-EVA-02	EVA gasket	Adhesive single side /650*15*1.5mm BLK		3pcs	
7	B-EVA-03	EVA gasket	LT_MB24-III232*18*1.5mm/adhesive single side	LT_MB24-III-109	2pcs	
8	B-EVA-04	EVA gasket	LT_MB24-III484*12*1.5mm/adhesive single side	LT_MB24-III-110	2pcs	
9	B-L36-01	screw	H/H6*30M D=10/stainless black	LT_MB24-III-104	16pcs	
10	B-LBD01	woofer	B&C12 /32YBX100		2pcs	
11	B-EVA-06	EVA gasket	LT_MB24-III280.8*316.8*30mm/adhesive single side	LT_MB24-III-107	2pcs	
12	BTXTRQLW-SM005	Cabinet	BOSE/LT MB24-WR/PLY		1pcs	
13	BT-DZBZ2-SM020	panel input Assy	BOSE/LT MB24-WR		1pcs	
14	B-L34-01	screw	T4.7*12mm/M/stainless/black	LT_MB24-III-111	8pcs	
15	B-EVA-01	EVA gasket	LT_MB24-III178*88*1.5mm/adhesive single side	LT_MB24-III-105	1pcs	
16	B-L310-01	smart rigging 31-16 (mm)	q30*M14*M9.9*35mm stainless	LT97902-III-103	16pcs	
17	B-L310-02	screw	CH11.7*9.9*20mm/M/stainless/black	LT97902-III-109	16pcs	
18	L-DP-09	washer	PVC/q15.9*9.6*0.4mm		16pcs	
19	BT-BPZL-SM001	logo kits	BOSE/BLK		1pcs	
20	B-EVA-0C	EVA gasket	LT_MB24-III672*43*1.0mm/adhesive single side	LT_MB24-III-108	2pcs	

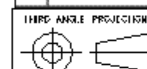

THIRD ANGLE PROJECTION

NOTE

LEVEL	REV. NO.	DATE
3	CHECKER	09-09-01
2	ENGINEER	09-09-01
1	REL FOR PROD. PER AL REV	08-08-01

DESCRIPTION

ASSY LOUDSPEAKER LT MB12-WR.LTFR

REV. NO.	CLASS	DATE	REV. NO.
0	PT	09-09-01	01

SCALE	CN. CODE	SHEET 1 OF 1